

KILDARE COUNTY COUNCIL
TAKING IN CHARGE POLICY & SPECIFICATIONS

Appendix 12

Taking in Charge Drawing Requirements

Q2 2023

Kildare County Council as Built Drawing Specifications

As Built Drawing General Specifications

- As built drawings shall be provided in the Health and Safety File as part of the Taking in charge process. Any changes that have been made since the Planning stage shall be clearly indicated in drawing revisions/notes/rev clouds.
- All approved changes made onsite during the construction phase must be recorded and should be reflected on the submitted drawings. All changes should be clearly indicated in drawing revisions/notes/rev clouds.
- Drawings are to be submitted in both AutoCAD compatible (dwg/dxf) format and Pdf as required by the different appendices to the taking in charge Policy and Specifications. All Drawings to be geo-coordinated & scaled to ITM and all levels related to fixed Ordnance Survey Datum (Malin Head).
- Mapping of SuDs features shall be undertaken in compliance with the recommendations of “SuDS asset register and mapping” by HR Wallingford February 2019.
- All Plan scales should be in common use, i.e. 1:500, 1:1000, or 1:2500 as appropriate and the different services (i.e. foul drainage, surface water, water and public lighting) should have their own individual layers. The drawings should be scalable to 1:1000 or 1:500 with all items, text and symbols etc remaining legible.
- All drawings should be set out on OS background tiles – OS tiles can be made available from Kildare County Council on request.
- North point must be included.
- All road names must be clearly marked.
- Total number of units in development is required.
- House numbers must be clearly marked.
- The colours used for as built infrastructure shall be as set out in table 1 below.

Colour	Layer	Colour Code
Grey	OS – OS mapping	128,128,128
Blue	WM – Watermain	0,63,255
Red	FW – Foul Water	255,0,0
Green	SW – Storm Water	63,127,63
Purple	PL – Public Lighting	147,39,143

TABLE 1 – AS CONSTRUCTED SERVICE COLOUR CODE

- Individual As Constructed drawings should be submitted for each service. The relevant services should be colour coded as per Table 1. All other services should be greyed out and visible to clearly show overlap and cross-over points.
- Watermains including all sluice valves, hydrants and air vales etc.to be annotated with SV / HYD / DFH / AV - See samples below. All pipe diameters are also to be clearly indicated. It must be clear on the drawing exactly what each SV isolates, when switched off.

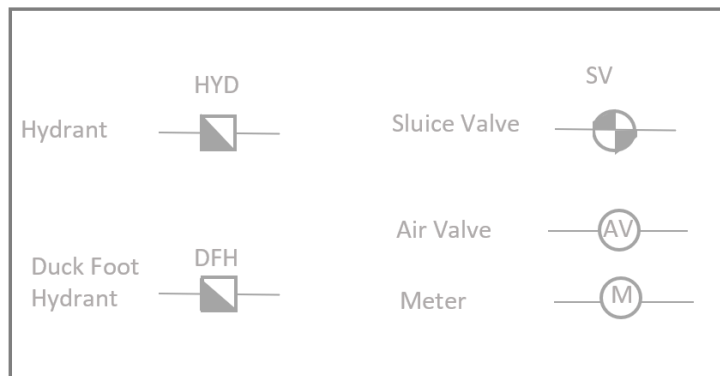

FIGURE 1 - WATERMAIN

- All manholes should be indicated by a solid circle in their respective colours. They must be individually referenced with the cover, invert and backdrop levels (relating to O.S.I Malin Ordnance Datum) noted on a separate table/schedule.
- Foul sewer lines should be marked in red, as per Table 1, and must include pipe diameters. NOTE - Only main sewer lines needed, connections to buildings or house drains are not required
- Surface sewer lines should be marked in green, as per Table 1, and include pipe diameters. NOTE - Only main sewer lines needed, connections to buildings or house drains are not required
- Road gully positions & connections to main surface water sewers should be shown on the plans.
- The details and locations of road markings and signage including any traffic calming interventions, ramps etc should be included on the drawing.
- Public lighting poles should be shown and colour coded as per Table 1.
- Attenuation details to be shown.
- Junction visibility splay drawing to be provided with the ACD's. The 'X' and 'Y' distance are to be annotated on the drawing and the achieved Stopping Sight Distance (SSD) to the 0.26 object height and 1.06m eye object height to recorded.

Taking in Charge (TIC) Drawing Specification

The drawing(s) submitted taking in charge must be 'As Constructed' and must show all roads, footpaths, verges, open spaces, areas under management, parking areas, houses garden boundaries and site boundary. A template Kildare County Council Taking in Charge drawing in .dwg format is available and can should be downloaded from the KCC website (details to be included)

TIC drawings must comply, as a minimum, with the requirements listed and tabled below:

- Drawings are to be submitted in both AutoCAD compatible (dwg/dxf) format and Pdf.
- All Drawings to be geo-coordinated & scaled to ITM and all levels related to fixed Ordnance Survey Datum (Malin Head).
- North point must be included.
- The estate boundary to be depicted in blue.
- Areas to be taken in charge i.e., carriageway, cycle paths, footway and parking spaces are to be indicated by a solid red line. Hatching should be completed in small sections to speed up editing if changes have to be made.

NOTE - Parking spaces will only be taken in charge if they have not been sold or allocated to homeowners – dedicated and non-dedicated/public car parking spaces should be clearly indicated.

- Areas not taken in charge must be clearly hatched.
- Areas that will remain under the control of a management company must be clearly hatched.
- All road names must be clearly marked.
- House numbers must be clearly marked.
- Services to be clearly shown and included in drawing legend.

Colours used in TIC Maps						
<i>Description</i>	<i>Colour</i>	<i>RGB Colour AutoCad</i>	<i>Hatch</i>	<i>Global Width/Scale</i>	<i>Line</i>	<i>Transparency</i>
OS – OS mapping	Grey	128,128,128			Continuous	
BD – Site Boundary	Blue	255,0,0		1,000	Continuous	
TIC – Area to be Taken in Charge	Red	0,63,255		1,000	Continuous	
Area Not to be Taken in Charge	Grey	99,100,102	ANS137	750		
Area already Taken in Charge	Grey	99,100,102	ANS131	750		
Area to be maintained by management company	Orange	195,90,19	ANS137	750		

Open Space	Green	63,127,63	Solid			
CW- Carriageway	Grey	166,166,166	Solid			
FP – Footpath/cycleway	Grey	214,214,214	Solid			
Wayleave	Yellow	255, 255, 127	Solid			

See sample Taking in Charge Drawings below

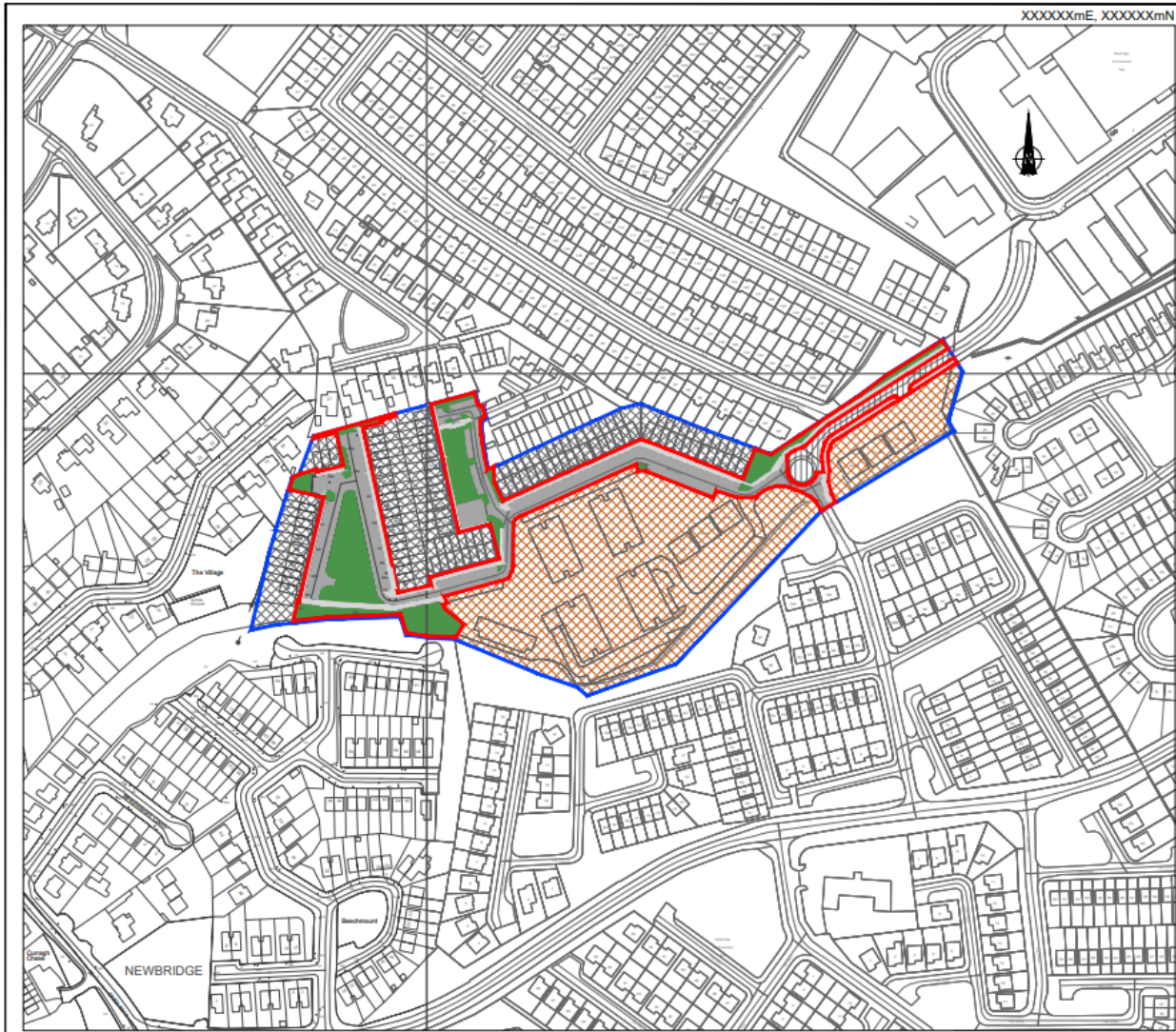

Notes:
 1. No dimensions to be scaled from this drawing.
 2. All sizes to be checked on site and any discrepancies to be reported to the engineer.

- Legend:
- Area to be Taken in Charge
 - Estate Site Boundary
 - Open Space
 - Road Area
 - Path Area
 - Area Not to be Taken in Charge
 - Area to be maintained by management company
 - Area Taken in Charge
 - Wayleave (Coloured yellow if applicable)

No.	Date	Issue / Revision	Chkd.

Project:
 DCXXXX address of site

Dwg. Title:
 TIC Display Map

From:
 N/A

To:
 N/A

OS Ref:
 XXXX-X

Area to be Taken in Charge: XXX Hectares	Folio: KEXXXX
---	------------------

Dwg. No. DCXXXX-DWG-TIC-00	Sheet A3	Pt. Ref. XXXXXX
Date XX/XX/XXXX	No. of Sheets XX	

Scale 1:XXXX	Drawn: XX	Checked by: XX
-----------------	--------------	-------------------



Roads & Transportation
 Building and Development Control
 Kildare County Council, Comhairle Chontae Chill Dara
 Áras Chill Dara, Devoy Park, Naas, Co. Kildare
 T: 353-45-980542 E: buildingcontrol@kildarecoco.ie

XXXXXXmE, XXXXXXmN
 Ordnance Survey Licence No. 2012/05/CCMA/Kildare County Council

DRAFT